

CASTABLE ANCHOR

V1.6(60)-070-310

TYPE Ø ANGLE LENGTH L ALLOY

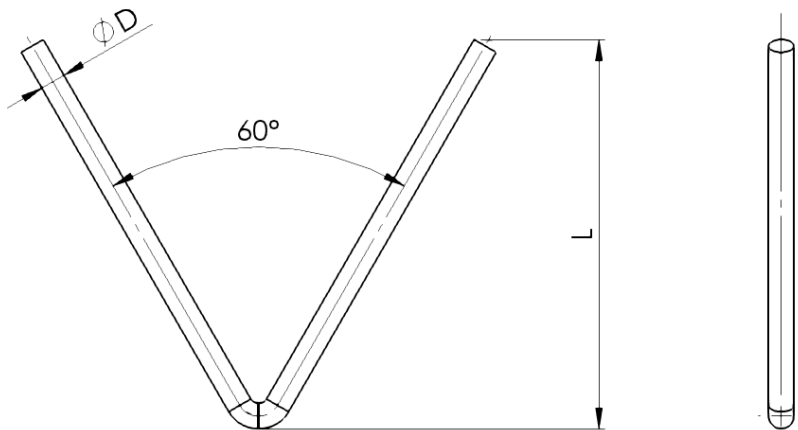

Anchors are manufactured with a DIN EN 10278 (DIN 671) cold drawn wire, by robots using hydraulic tools. That allows minimizing bend marking and avoids micro cracks

Our recommendations :

- CH anchor (PAGE A1-03) allows easier, stronger, safer welding
- Always cap your anchors, it will give a small space into which the thermal expansion steel alloy (higher than castable) can move without creating stress and possibly damaging in the castable.



France – phone : + 33 3 66 50 00 30
 anchorscontact@gmail.com
 www.anchorsforrefractory.com

Options : see details on page 6-1/6-2/6-3

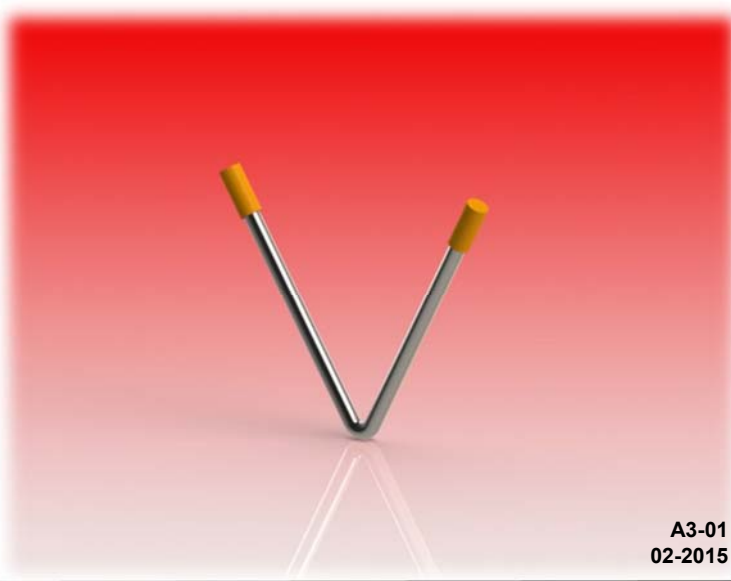
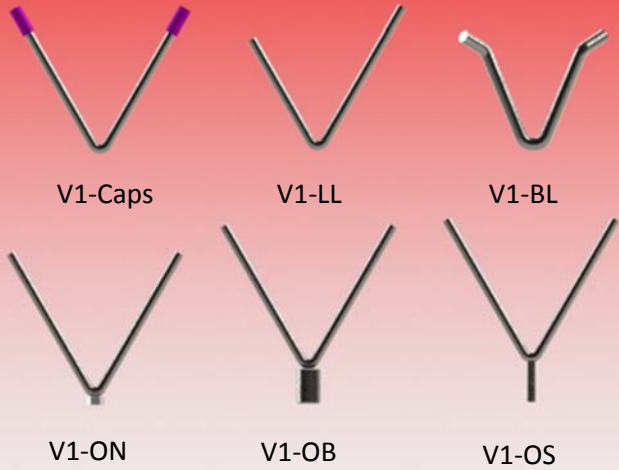

A3-01
02-2015

This drawing is the property of ANCHORS unauthorised use and / or reproduction of the drawing is prohibited. Informations mentioned are guide lines only and can be modified without previous notice .Please contact us if you want a liable specification

A-CASTABLE ANCHOR

CASTABLE ANCHOR

V4.6(60)-070-310

TYPE Ø ANGLE LENGTH L ALLOY

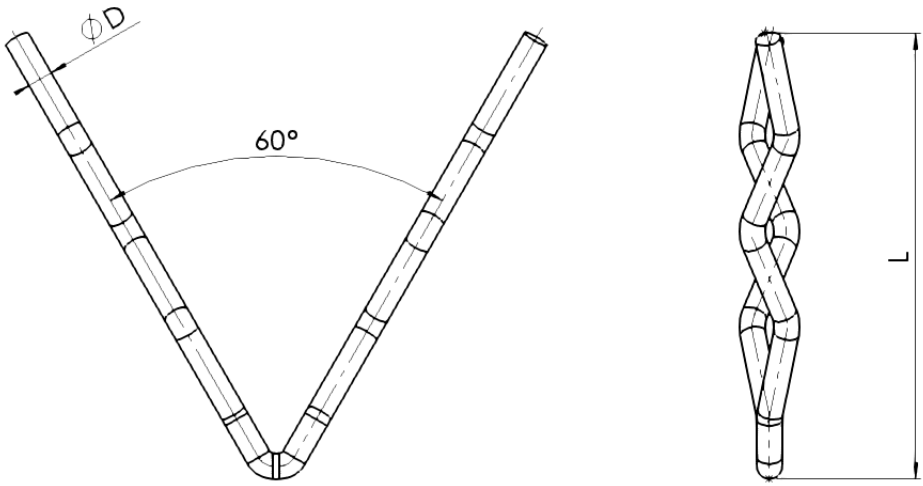

Anchors are manufactured with a DIN EN 10278 (DIN 671) cold drawn wire, by robots using hydraulic tools. That allows minimizing bend marking and avoids micro cracks

Our recommendations :

- CH anchor (PAGE A1-03) allows easier, stronger, safer welding
- Always cap your anchors, it will give a small space into which the thermal expansion steel alloy (higher than castable) can move without creating stress and possibly damaging in the castable.



France – phone : + 33 3 66 50 00 30
 anchorscontact@gmail.com
 www.anchorsforrefractory.com

Options : see details on page 6-1/6-2/6-3

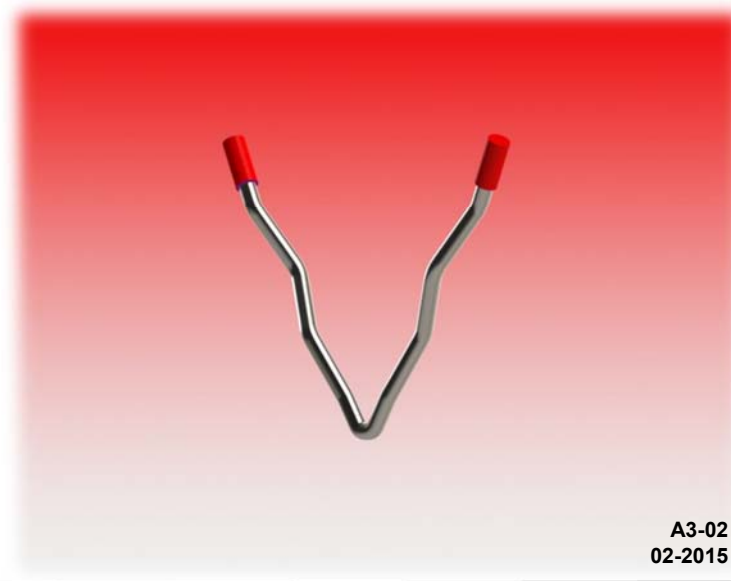
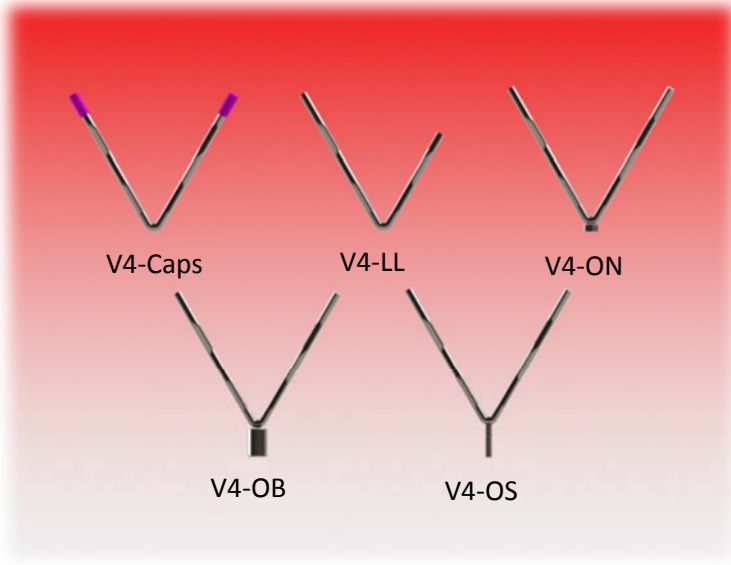

A3-02
02-2015

This drawing is the property of ANCHORS unauthorised use and / or reproduction of the drawing is prohibited. Informations mentioned are guide lines only and can be modified without previous notice .Please contact us if you want a liable specification

A-CASTABLE ANCHOR