

CASTABLE ANCHOR

TWA.8(60)-180(80)-32-310

TYPE	Ø	ANGLE A	LENGTH L	STEP S	LENGTH R	ALLOY
------	---	------------	-------------	-----------	-------------	-------

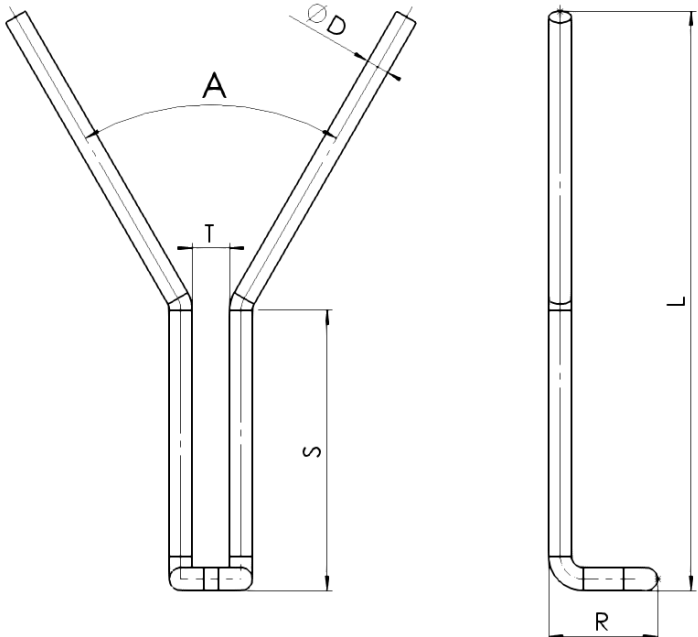

- Ø 6 mm T = 13 mm
- Ø 8 mm T = 13 mm
- Ø 10 mm T = 15 mm

$R = 4 \times \text{Ø}$

Anchors are manufactured with a DIN EN 10278 (DIN 671) cold drawn wire, by robots using hydraulic tools. That allows minimizing bend marking and avoids micro cracks

Our recommendations :

- The bent foot allows easier 90° positioning on steel casing and makes welding longer / stronger
- Always cap your anchors, it will give a small space into which the thermal expansion steel alloy (higher than castable) can move without creating stress and possibly damaging in the castable.



France – phone : + 33 3 66 50 00 30
 anchorscontact@gmail.com
 www.anchorsforrefractory.com

Options :



TWA-Caps



TWA-LL

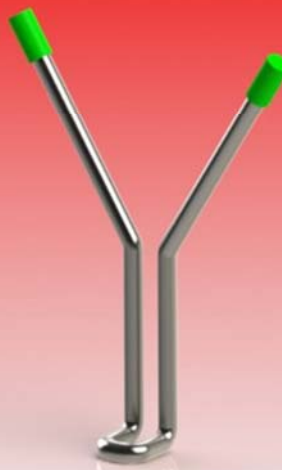

A8-01
02-2015

This drawing is the property of ANCHORS unauthorised use and / or reproduction of the drawing is prohibited. Informations mentioned are guide lines only and can be modified without previous notice .Please contact us if you want a liable specification

A-CASTABLE ANCHOR

TWM.8(60)-180(80)-32-304

TYPE	Ø	ANGLE A	LENGTH L	STEP S	LENGTH R	ALLOY
------	---	------------	-------------	-----------	-------------	-------

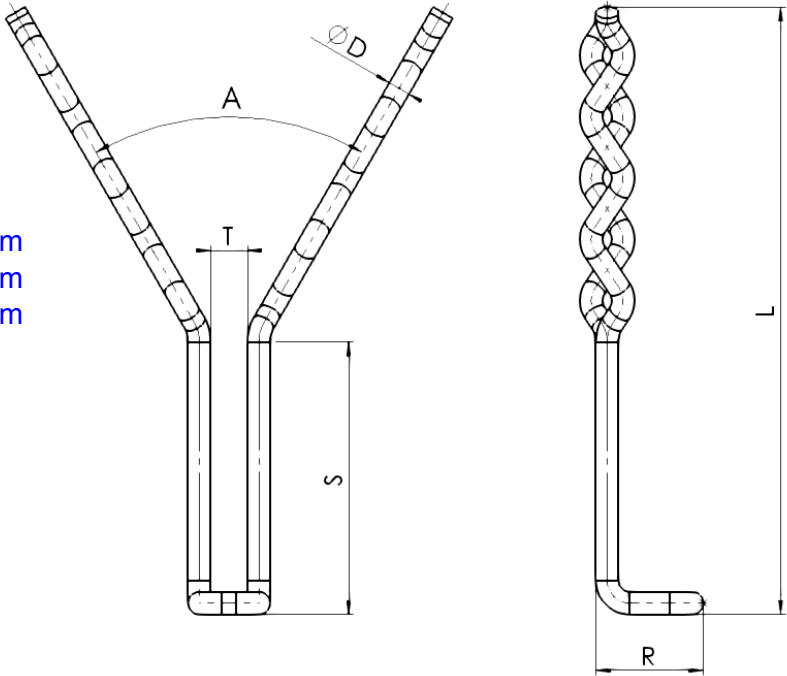

- Ø 6 mm T = 13 mm
- Ø 8 mm T = 13 mm
- Ø 10 mm T = 15 mm

$R = 4 \times \text{Ø}$

Anchors are manufactured with a DIN EN 10278 (DIN 671) cold drawn wire, by robots using hydraulic tools. That allows minimizing bend marking and avoids micro cracks

Our recommendations :

- The bent foot allows easier 90° positioning on steel casing and makes welding longer / stronger
- Always cap your anchors, it will give a small space into which the thermal expansion steel alloy (higher than castable) can move without creating stress and possibly damaging in the castable.



France – phone : + 33 3 66 50 00 30
 anchorscontact@gmail.com
 www.anchorsforrefractory.com

Options :

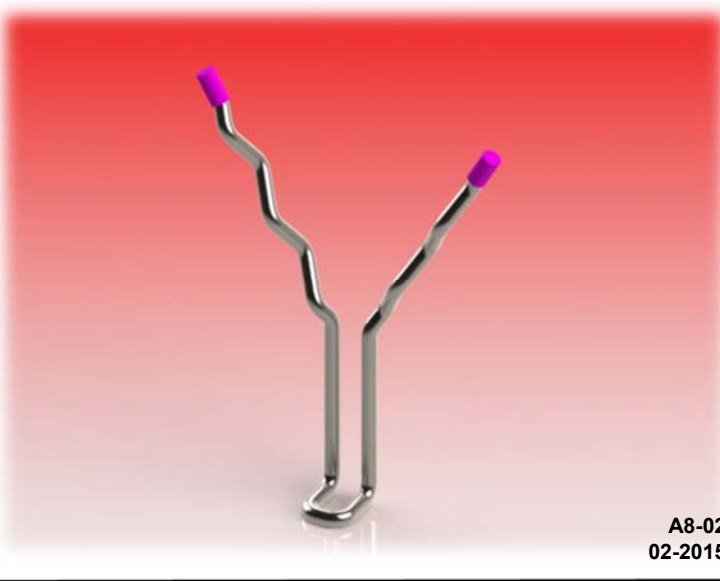
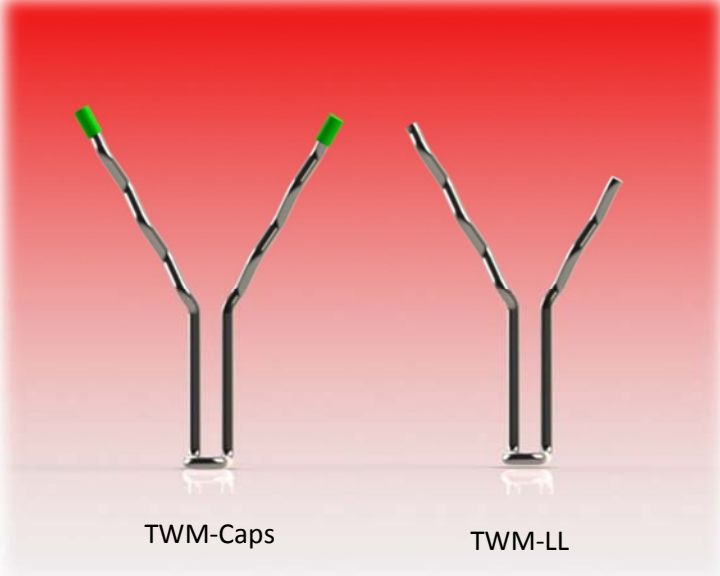

A8-02
02-2015

This drawing is the property of ANCHORS unauthorised use and / or reproduction of the drawing is prohibited. Informations mentioned are guide lines only and can be modified without previous notice .Please contact us if you want a liable specification

TWU.8(60)-160(80)-32-310

TYPE	Ø	ANGLE A	LENGTH L	STEP S	LENGTH R	ALLOY
------	---	------------	-------------	-----------	-------------	-------

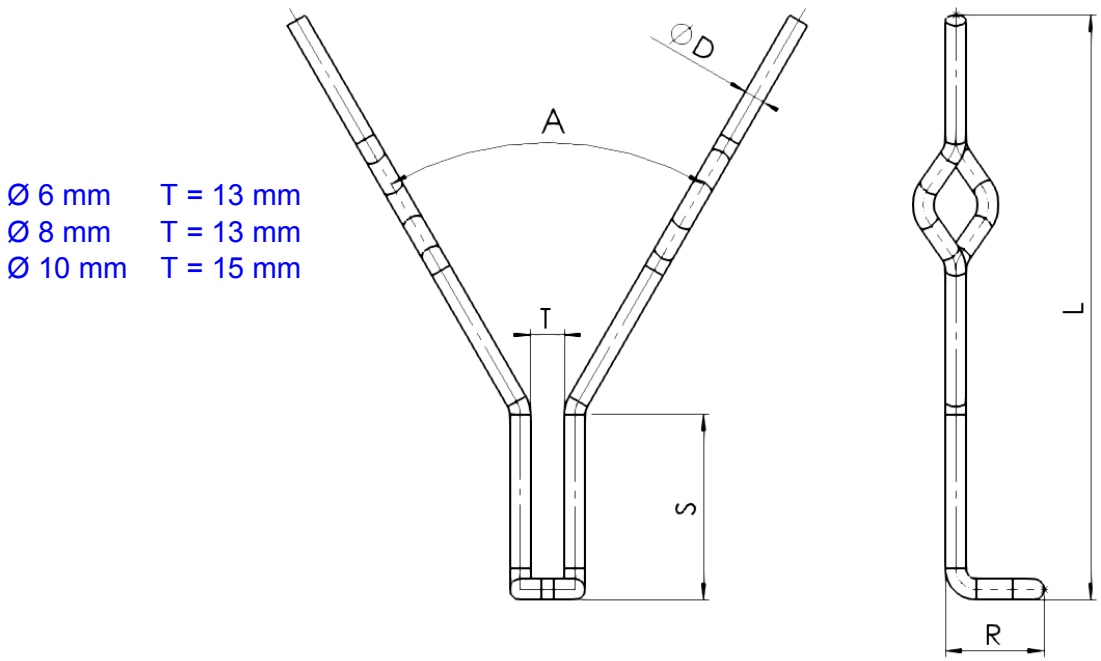

- Ø 6 mm T = 13 mm
- Ø 8 mm T = 13 mm
- Ø 10 mm T = 15 mm

$R = 4 \times \text{Ø}$

Anchors are manufactured with a DIN EN 10278 (DIN 671) cold drawn wire, by robots using hydraulic tools. That allows minimizing bend marking and avoids micro cracks

Our recommendations :

- The bent foot allows easier 90° positioning on steel casing and makes welding longer / stronger
- Always cap your anchors, it will give a small space into which the thermal expansion steel alloy (higher than castable) can move without creating stress and possibly damaging in the castable.



France – phone : + 33 3 66 50 00 30
 anchorscontact@gmail.com
 www.anchorsforrefractory.com

Options :

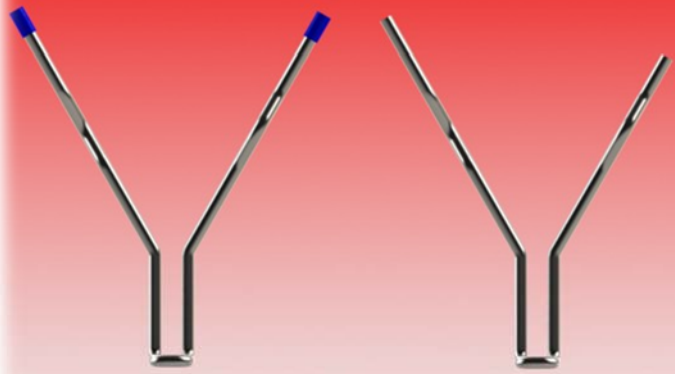

TWU-Caps

TWU-LL

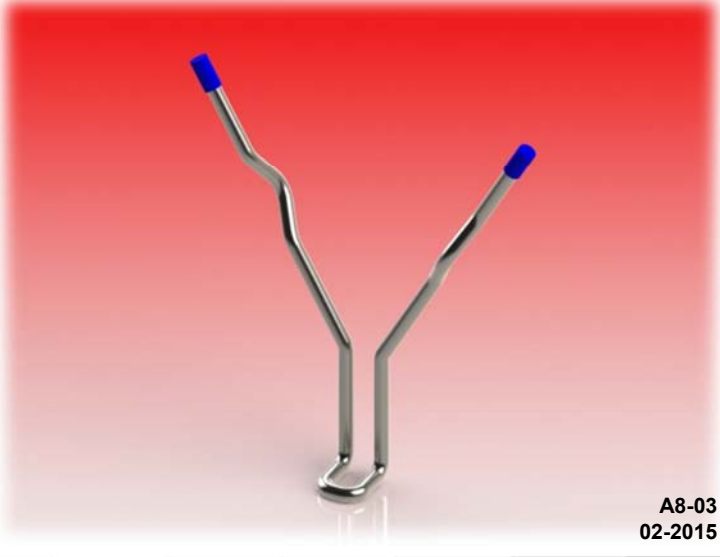

A8-03
02-2015

This drawing is the property of ANCHORS unauthorised use and / or reproduction of the drawing is prohibited. Informations mentioned are guide lines only and can be modified without previous notice .Please contact us if you want a liable specification

CASTABLE ANCHOR

TWS.10(60)-220(110)-40-330

TYPE	Ø	ANGLE A	LENGTH L	STEP S	LENGTH R	ALLOY
------	---	------------	-------------	-----------	-------------	-------

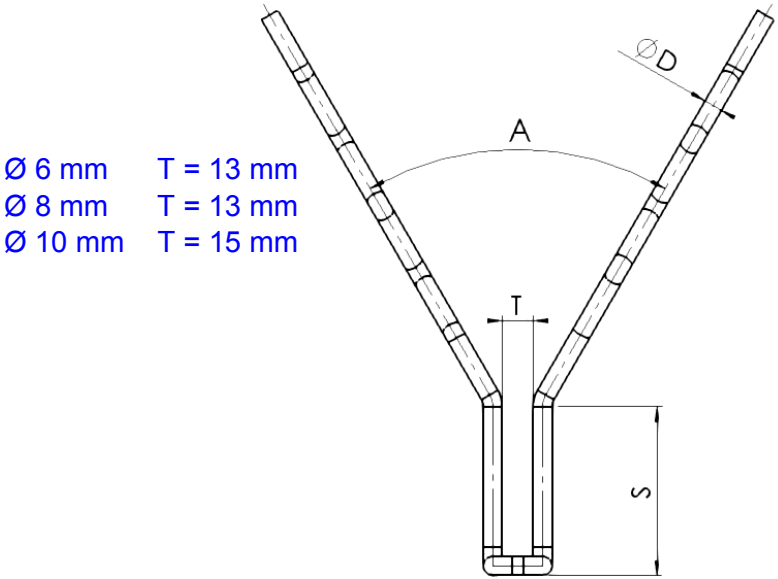

- Ø 6 mm T = 13 mm
- Ø 8 mm T = 13 mm
- Ø 10 mm T = 15 mm

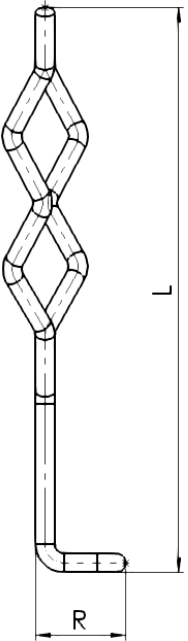

$R = 4 \times \text{Ø}$

Anchors are manufactured with a DIN EN 10278 (DIN 671) cold drawn wire, by robots using hydraulic tools. That allows minimizing bend marking and avoids micro cracks

Our recommendations :

- The bent foot allows easier 90° positioning on steel casing and makes welding longer / stronger
- Always cap your anchors, it will give a small space into which the thermal expansion steel alloy (higher than castable) can move without creating stress and possibly damaging in the castable.



France – phone : + 33 3 66 50 00 30
 anchorscontact@gmail.com
 www.anchorsforrefractory.com

Options :

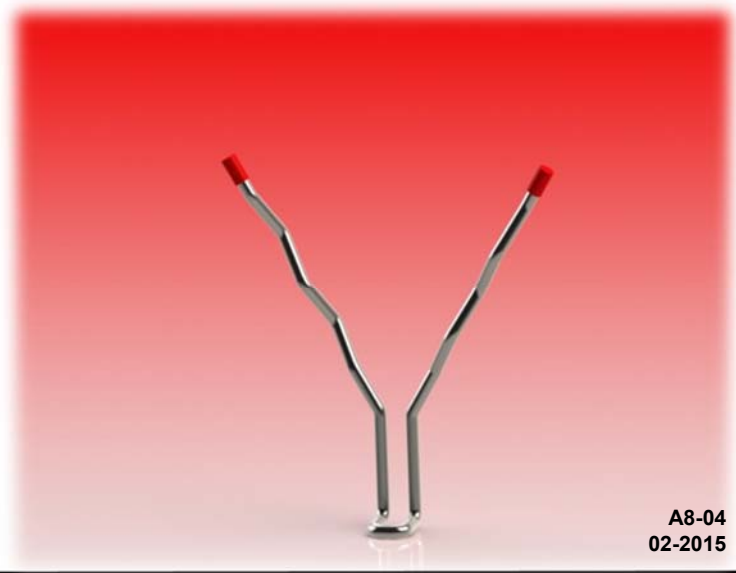
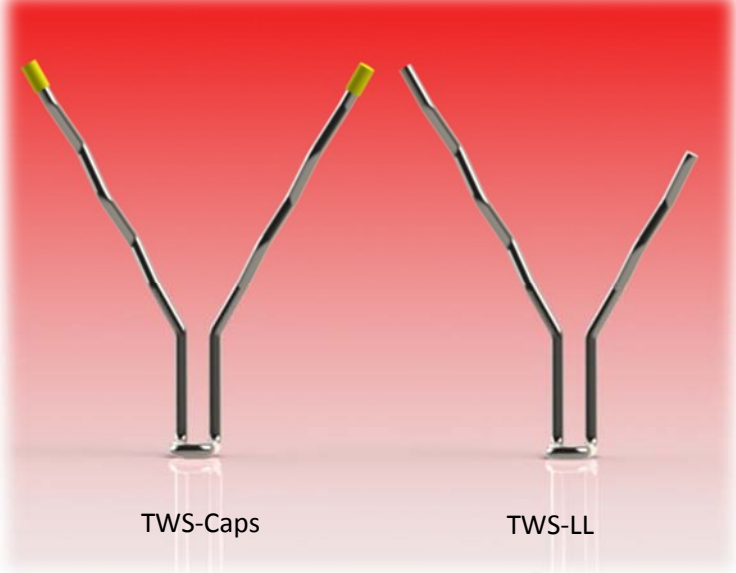

A8-04
02-2015

This drawing is the property of ANCHORS unauthorised use and / or reproduction of the drawing is prohibited. Informations mentioned are guide lines only and can be modified without previous notice .Please contact us if you want a liable specification

A-CASTABLE ANCHOR

CASTABLE ANCHOR

TWSS.10(90)-300(150-50)-40- 330

TYPE	Ø	ANGLE A	LENGTH L	STEP – S1	S	LENGTH R	ALLOY
------	---	------------	-------------	--------------	---	-------------	-------

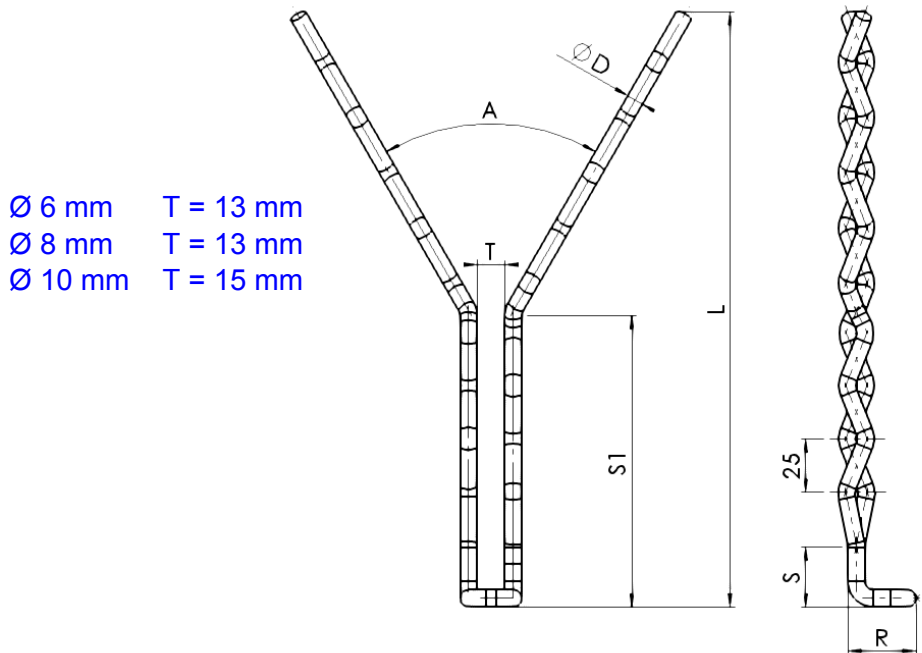

- Ø 6 mm T = 13 mm
- Ø 8 mm T = 13 mm
- Ø 10 mm T = 15 mm

Anchors are manufactured with a DIN EN 10278 (DIN 671) cold drawn wire, by robots using hydraulic tools. That allows minimizing bend marking and avoids micro cracks

Options :

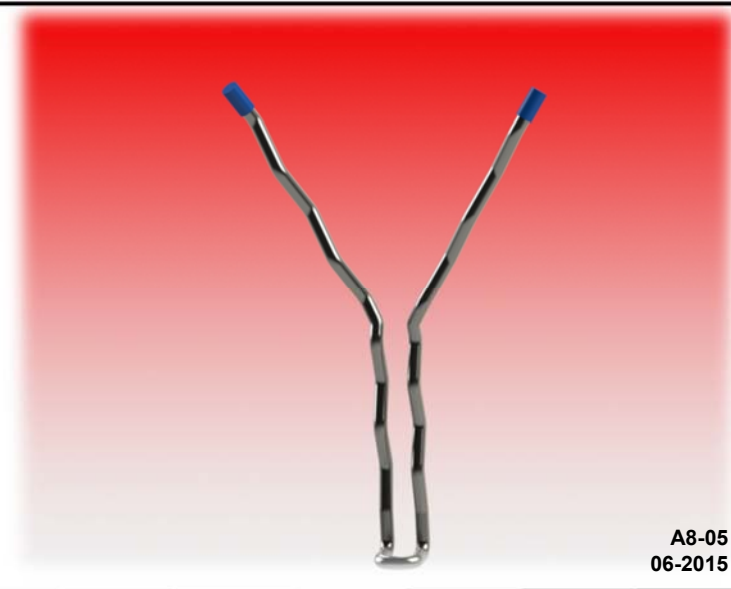
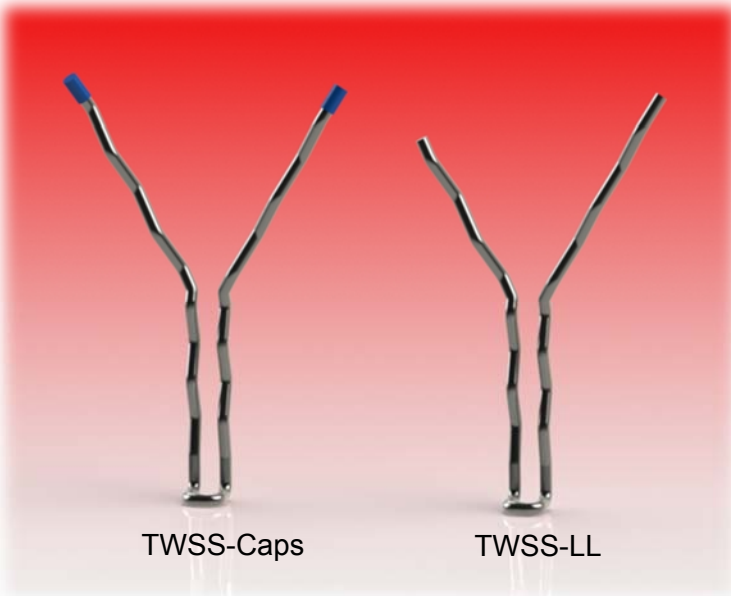

Our recommendations :

- The bent foot allows easier 90° positioning on steel casing and makes welding longer / stronger
- Always cap your anchors, it will give a small space into which the thermal expansion steel alloy (higher than castable) can move without creating stress and possibly damaging in the castable.
- The straight down part is also corrugated, that improves anchoring of a backup gunned insulating concrete layer



France – phone : + 33 3 66 50 00 30
 anchorscontact@gmail.com
 www.anchorsforrefractory.com

A8-05
06-2015

This drawing is the property of ANCHORS unauthorised use and / or reproduction of the drawing is prohibited. Informations mentioned are guide lines only and can be modified without previous notice .Please contact us if you want a liable specification

A-CASTABLE ANCHOR